

## Pad Eye Oblong + Ring

**Material:** Stainless Steel

**Class Grade:** A2-70 G304

**Corrosion Protection Level:** Excellent

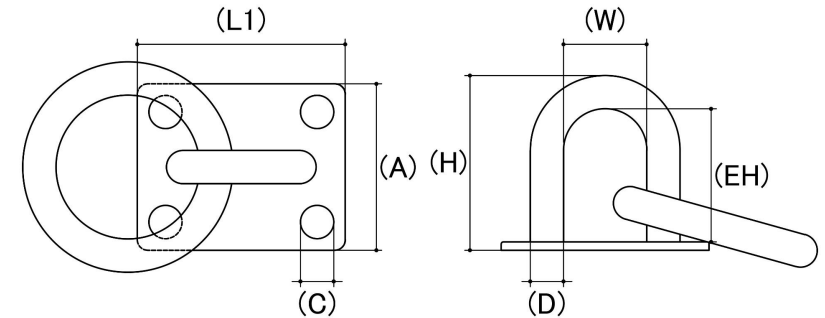

*CAD drawings shown for graphic representation only.\**

Size	Length L (1) (mm)	Height Overall (H) (mm)	Eye Diameter (D) (mm)	Inside Eye Width (W) (mm)	Height Of Eye (EH) (mm)	Width (A) (mm)	Hole Size (C) (mm)	sku (qfind)
	Nom	Nom	Nom	Nom	Nom	Nom	Nom	
5mm	35.00	19.00	5.00	14.00	12.00	30.00	4.20	62PEORS530
6mm	40.00	26.00	6.00	18.00	17.00	35.00	4.20	62PEORS635
8mm	50.00	33.00	8.00	20.00	22.00	40.00	5.20	62PEORS840

**Disclaimer:**

Dimensional data and technical information was obtained from publically available sources and not acquired through standard agencies. It has been completed and compiled for reference purposes only; where discrepancies are found they are subject to change without notice. Bolt & Nut Australia makes no warranties or representations regarding the accuracy and validity of the compiled information and data. Contact the relevant standard authorities for accurate and detailed information.

\* CAD drawings may not reflect diameter, thread length or overall length.

© Bolt & Nut Australia Pty Ltd. All rights reserved.

Version: 18 Mar 2024